

17.007 (3000 PSI)

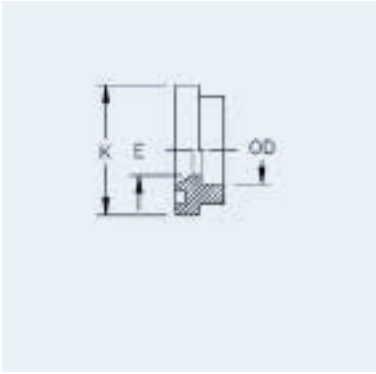

Braze Flange Code 61

SAE Flansch-Schulter zum Einlöten Code 61

Collet SAE à braser Code 61

Flangia SAE de brasare Code 61

Espesor de brida SAE para ser soldado Code 61

| Part Number | Thread T | Flange | Tube O.D. mm | ND | Size | A mm | E mm | K Ø mm | Max. Oper. Press. bar |
|--------------|----------|--------|--------------|----|------|------|------|--------|-----------------------|
| 17.007-15-8 | | 1/2" | 15 | 12 | -8 | | 12,0 | 30,2 | 345 |
| 17.007-22-12 | | 3/4" | 22 | 19 | -12 | | 18,0 | 38,1 | 345 |
| 17.007-28-16 | | 1" | 28 | 25 | -16 | | 25,0 | 44,4 | 345 |
| 17.007-35-20 | | 1 1/4" | 35 | 31 | -20 | | 30,0 | 50,8 | 275 |
| 17.007-42-24 | | 1 1/2" | 42 | 38 | -24 | | 36,0 | 60,3 | 210 |
| 17.007-55-32 | | 2" | 55 | 51 | -32 | | 49,0 | 71,4 | 210 |
| 17.007-65-40 | | 2 1/2" | 65 | 60 | -40 | | 60,1 | 84,1 | 175 |
| 17.007-75-48 | | 3" | 75 | 75 | -48 | | 70,0 | 101,6 | 140 |

SAE Standard Pressure Series.
Max. working pressure see G74446-Size.
Material: 11SMnPb30

SAE Standard Pressure Series.
Max. working pressure see G74446-Size.
Material: 11SMnPb30

SAE Standard Pressure Series.
Max. working pressure see G74446-Size.
Material: 11SMnPb30

SAE Standard Pressure Series.
Max. working pressure see G74446-Size.
Material: 11SMnPb30

SAE Standard Pressure Series.
Max. working pressure see G74446-Size.
Material: 11SMnPb30

17.008 (6000 PSI)

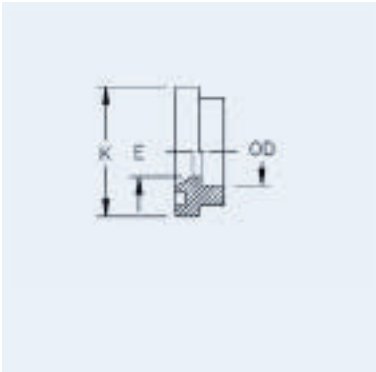

Braze Flange (Shoulder) Code 62

SAE Flansch-Schulter zum Einlöten Code 62

Collet SAE à braser Code 62

Flangia SAE de brasare Code 62

Espesor de brida SAE para ser soldado Code 62

| Part Number | Thread T | Flange | Tube O.D. mm | ND | Size | A mm | E mm | K Ø mm | Max. Oper. Press. bar |
|--------------|----------|--------|--------------|----|------|------|------|--------|-----------------------|
| 17.008-16-8 | | 1/2" | 16 | 12 | -8 | | 12,0 | 31,8 | 415 |
| 17.008-20-12 | | 3/4" | 20 | 19 | -12 | | 16,0 | 41,3 | 415 |
| 17.008-25-12 | | 3/4" | 25 | 19 | -12 | | 18,0 | 41,3 | 415 |
| 17.008-30-16 | | 1" | 30 | 25 | -16 | | 23,0 | 47,6 | 415 |
| 17.008-35-20 | | 1 1/4" | 35 | 31 | -20 | | 27,0 | 54,0 | 415 |
| 17.008-42-24 | | 1 1/2" | 42 | 38 | -24 | | 32,0 | 63,5 | 415 |
| 17.008-55-32 | | 2" | 55 | 51 | -32 | | 45,0 | 79,4 | 415 |

SAE High Pressure Series.
Max 415 bar working pressure.
Material: 11SMnPb30

SAE High Pressure Series.
Max 415 bar working pressure.
Material: 11SMnPb30

SAE High Pressure Series.
Max 415 bar working pressure.
Material: 11SMnPb30

SAE High Pressure Series.
Max 415 bar working pressure.
Material: 11SMnPb30

SAE High Pressure Series.
Max 415 bar working pressure.
Material: 11SMnPb30